

KEYLESSH2

THE SIMPLE HASP

✓ SIMPLE ✓ SUSTAINABLE ✓ SECURE

SIMPLY PERFECT. PERFECTLY SIMPLE.

SIMPLE to install and operate, our hasp lock is perfect for assigned or shared use in wet or dry areas.

SUSTAINABLE with a solid metal design and no batteries, wires, or harmful waste these locks qualify for two LEEDV4 credits.



OUR CLIENTS



Mercedes-Benz



KEYLESSH2

ARCHITECTURAL SPECIFICATIONS



PART NUMBER:
KEYLESSH2-SN
STANDARD FINISH:
SATIN NICKEL



PART NUMBER:
KEYLESSH2-MB
PREMIUM FINISH:
MATTE BLACK
MUNSELL N2/



PART NUMBER:
KEYLESSH2-MW
PREMIUM FINISH:
MATTE WHITE
MUNSELL N9/



PART NUMBER:
KEYLESSH2-SG
PREMIUM FINISH:
SATIN GOLD
MUNSELL N9/

10% color discrepancy, and custom pricing options apply.

- Shared (temporary) or assigned (permanent) use, depending on padlock
- Compatible with wood, glass, plastic, phenolic & metal locker doors
- Zero operating expenses - No batteries or wires
- LEED V4 certified - adds 2 LEED credits
- Ergonomic non-slip grip knob
- The hasp accepts padlock shackles up to 11 mm thick
- IP69K - Complete dust and water resistance
- Strong 100% metal for long-term heavy-use - no plastic components
- Accommodates doors 1-23mm thickness
- When disinfecting, mist with liquid that is at least 70% alcohol solution in order to maintain product integrity
- **Immediate live response during business hours - no run around.** (sos@keyless.co or 972.331.2770)

TOP VIEW

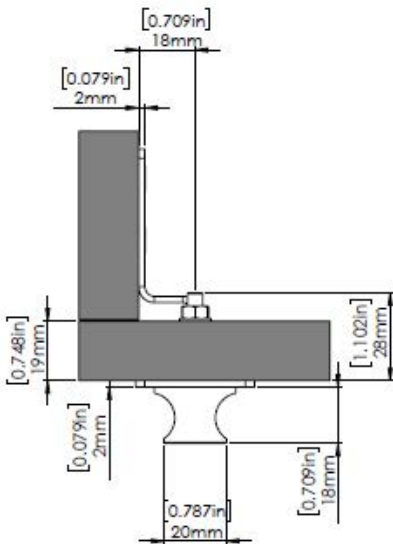

SIDE VIEW

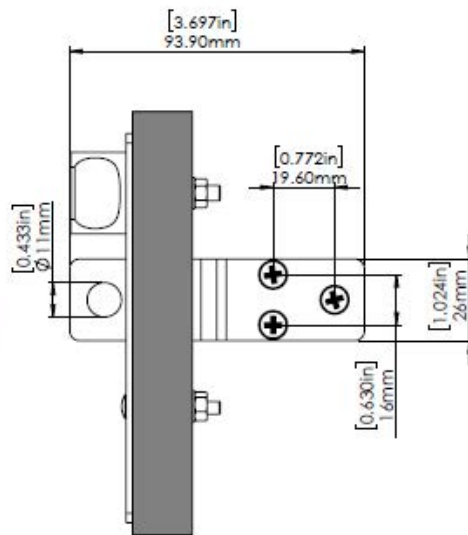

FRONT VIEW

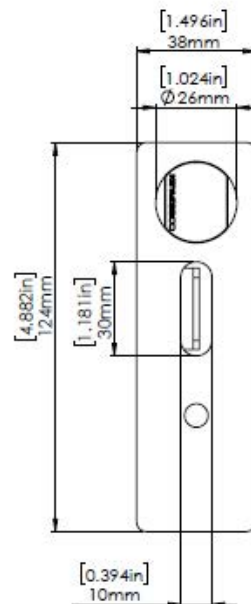

DOOR ROUTING

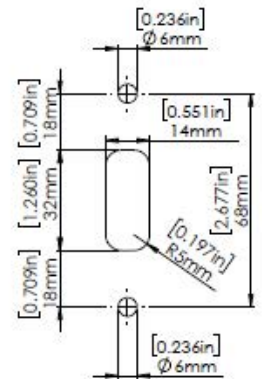

Manufactured By:

KEYLESS.CO

1825 W. Walnut Hill Ln., Suite 102, Irving, TX 75038, USA | +1 972-331-2770 | info@keyless.co | www.keyless.co | V: 12/14/20210