

# SERO COAT HOOK

## ARCHITECTURAL SPECIFICATIONS

**MATERIAL: ZINC ALLOY 5**



- **PART NUMBER:**  
SERO-HOOK-SN
- **FINISH(STANDARD)**  
Satin Nickel
- **FINISHING PROCESS:**  
Electroplating



- **PART NUMBER:**  
SERO-HOOK-MB
- **FINISH(PREMIUM):**  
Matte Black | Munsell N2
- **FINISHING PROCESS:**  
Electrodeposition Coating



- **PART NUMBER:**  
SERO-HOOK-MW
- **FINISH(PREMIUM):**  
Matte White | Munsell N9
- **FINISHING PROCESS:**  
Epoxy Painting



- **PART NUMBER:**  
SERO-HOOK-SG
- **FINISH(PREMIUM):**  
Satin Gold | Pantone #871C
- **FINISHING PROCESS:**  
Epoxy Painting

10% color discrepancy, and custom pricing options apply.

- **MATERIAL:** Zinc Alloy 5
- **FINISHES:** Satin Nickel, Matte Black, Matte White, Satin Gold
- **INCLUDED:** Satin nickel screws (quantity: 2)
- **TESTED:** Rust-resistant and perfect for humid environments

- **CLEANING:** When disinfecting, mist with at least 70% alcohol solution in order to maintain product integrity
- **WEIGHT CAPACITY:** 50 lbs

### TOP VIEW

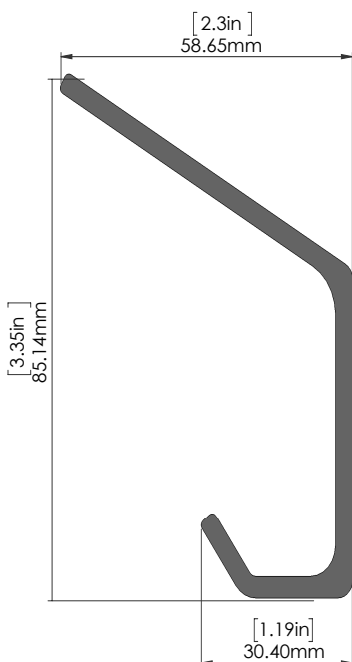

### FRONT VIEW

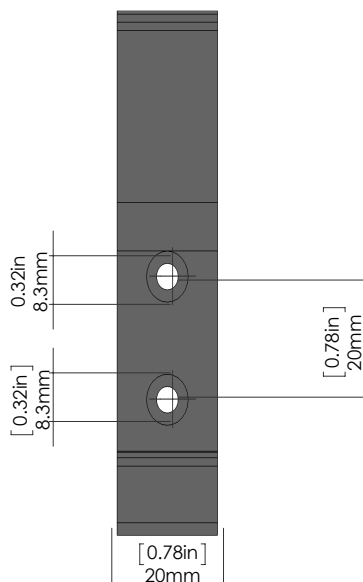

### BACK VIEW

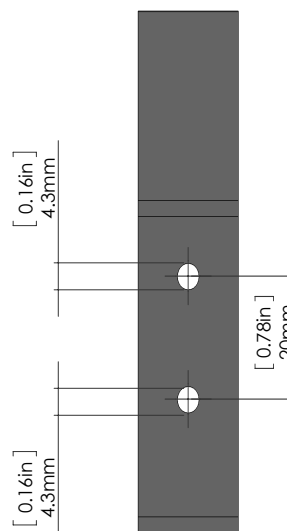

### SCREWS

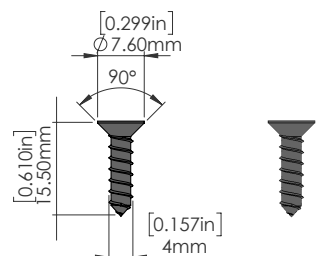

Manufactured By:

**KEYLESS.CO**

1825 W. Walnut Hill Ln., Suite 102, Irving, TX 75038, USA | +1 972-331-2770 | info@keyless.co | www.keyless.co | V: 3/4/2021